

SM-01 PAS Sensor

1. Function overview

The sensor, mounted on the right side of the electric bike, has a built-in highly sensitive Hall component that can detect the running state of the electric bike in real time. When the pedal turns forward, the sensor outputs a pulse signal.

2. Product dimensions

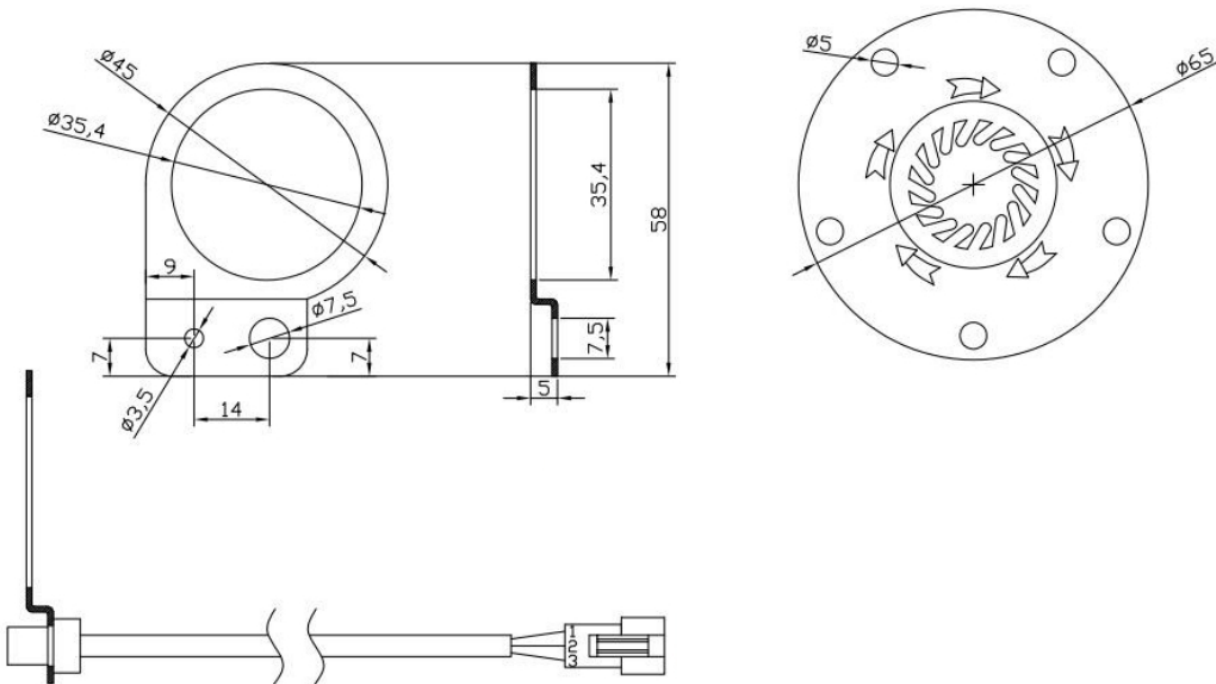

3. Specifications

- Working voltage: 4.5-6V(DC)
- Quiescent Current: < 5mA
- Maximum working current: < 6mA
- Number of pulses: 5/6
- Wire tension: > 20N
- Hall response time: <0.001s
- Waterproof grade: IP67
- Material: ABS

4. Output waveform

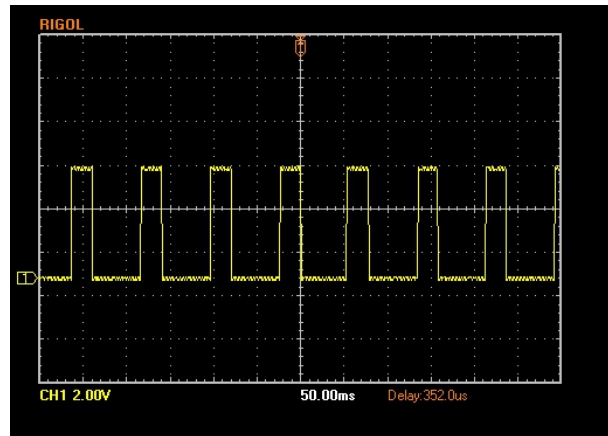

5. Wiring sequence definition

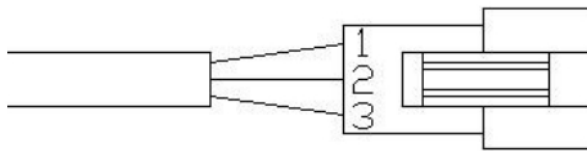

1	Blue	Assist signal
2	Red	+5V
3	Yellow	GND

6. Product picture

